

INITIAL RECEIPT

**United States Department of the Interior
Bureau of Land Management
DIV OF LANDS, MINRLS & ENERGY
ONE N CENTRAL AVE
PHOENIX, AZ 85004 -4427
Phone: 602-417-9200**

Receipt	
No:	4769889

Transaction #: 4896695
Date of Transaction: 07/27/2020
CUSTOMER:
DAVID IOLI 310 W 21ST AVE APACHE JUNCTION, AZ 85120-7710 US

LINE #	QTY	DESCRIPTION	REMARKS	UNIT PRICE	TOTAL
1	1.00	LOCATABLE MINERALS / MINING CLAIMS-NEW, UNADJUD, ONE OR MORE AUTH NOS / NEW MINING CLAIM PROCESSING FEE CASES: AMC460690/\$20.00		- n/a -	20.00
2	1.00	LOCATABLE MINERALS / MINING CLAIMS-NEW, UNADJUD, ONE OR MORE AUTH NOS / NEW MINING CLAIMS LOCATION FEE CASES: AMC460690/\$40.00		- n/a -	40.00
3	1.00	LOCATABLE MINERALS / MINING CLAIMS-NEW, UNADJUD, ONE OR MORE AUTH NOS / NEW MINING CLAIMS MAINTENANCE FEE CASES: AMC460690/\$165.00		- n/a -	165.00
4	1.00	OVERPAYMENT / OVERPAYMENT OF FEES / OVERPAYMENT OF \$1.00 OR MORE		30.00	30.00
TOTAL:					\$255.00

PAYMENT INFORMATION				
1	AMOUNT:	255.00	POSTMARKED:	N/A
	TYPE:	CHECK	RECEIVED:	07/24/2020
	CHECK NO:	558078		
	NAME:	VEZZETTI, JOHN C 310 W 21ST AVE APACHE JUNCTION AZ 85120-7710 US		

REMARKS

ENTERED
JUL 29 2020
BY: *ZMV*

This receipt was generated by the automated BLM Collections and Billing System and is a paper representation of a portion of the official electronic record contained therein.

7/27/2020

CORRESPONDENCE

TRANSFERS

MAINTENANCE FEES

WAIVERS

POL/NOI

MISCELLANEOUS

**LOCATION NOTICES
AMENDMENTS
STATUS SHEET
GEO REPORT/MTP**

MINING CLAIM STATUS REPORT - Assessment Year 2020

Data Entered: 7/29/2020 m

MTP Checked By: m
GEO Checked By: m

LEAD SERIAL NUMBER: AMC 460690 thru AMC _____

NUMBER OF CLAIMS & TYPE:

1 ~~3~~ LODE

TUNNEL SITE

CHARGES:

Processing Fee @ \$20 = \$ 20
Location Fee @ \$40 = \$ 40
Maintenance Fee @ \$165 = \$ 165
Add'l Maint Fee for Assoc Placer = \$ _____
SUBTOTAL \$ _____
Other Fees \$ _____
Other Fees \$ _____
TOTAL \$ 225

TOTAL ACREAGE: _____ Per Claim
(Placer Only)

NUMBER OF LOCATORS: _____

DOCUMENTS RECEIVED VIA: Over-the-Counter [] Mail **TIMELY FILED:** Yes No []

LEGAL DESCRIPTION: T 155 R 28E SEC 10
T _____ R _____ SEC _____
T _____ R _____ SEC _____
T _____ R _____ SEC _____
T _____ R _____ SEC _____

BLM [] FOREST SERVICE [] _____ SUBJ TO PL 359: Yes [] No []
WILDERNESS AREA [] _____

SPLIT ESTATE: N/A [] SX [] PX [] OTHER [] _____
SRHA [] Was proper Notice filed if located on SHRA Land? Yes [] No []

RECONVEYED MINERALS ON BLM LAND REQUIRE OPENING ORDER FROM 1944 TO 1993:

Open to Entry On _____ N/A []

COMMENTS/STATUS: VOID [] PARTIALLY VOID [] PVT MINERALS [] WITHDRAWN LANDS []
OTHER [] _____

AMC460690

[] Claimant acknowledges that portions of the following claim(s) site(s) may be void or voidable.

Printed Name of Claimant _____ Signature of Claimant _____

*****FINAL ADJUDICATION*****

DATE _____ INITIALS _____

LOCATION NOTICE FOR LODE MINING CLAIM

NOTICE IS HEREBY GIVEN that the Puerto del
Dado lode mining claim has been located
by David V. Vezette whose current mailing
address is 310 W. 21ST AVE.
Apache Junction 85120

RECEIVED
BLM STAFF OFFICE
2020 JUL 24 P 12:44
PHOENIX, ARIZONA
BLM
Date
Stamp

The general course of this claim is North East To South West and it is situated in Cochise
County, Arizona. This claim is 1500 feet in length and 600 feet in width. This claim runs
from the location monument on which this location notice is posted approximately 1400 feet in a
South direction to the South end line and 100 feet in a Northeast direction to the
NORTH end line. This claim is marked by six monuments, one at each corner and one at the center of each
end line of the claim.

The location monument on which this notice is posted is situated within Section 10, Township 15 S.
Range 28 East, Gila Salt River Base and Meridian, Arizona and this claim encompasses portions
of the following quarter section (s), section (s), Township (s) and Range (s) Sec. 10 Township
15 S. Range 28 East in the SE 1/4 Sec of 10
Gila Salt River Base and Meridian, Arizona.

The locality of this claim with reference to some natural object or permanent monument and additional information
(if any) concerning its locality are as follows: APPROXIMATELY 125 FEET
SOUTH EAST OF QUILLAN WELL

DATED AND POSTED on the ground this 18 day of July, 2020
LOCATOR (s) David Vezette and John Vezette

Form MCF100
Revised July 2005

AMC460690

MINING CLAIM MAP

Lode Placer ()

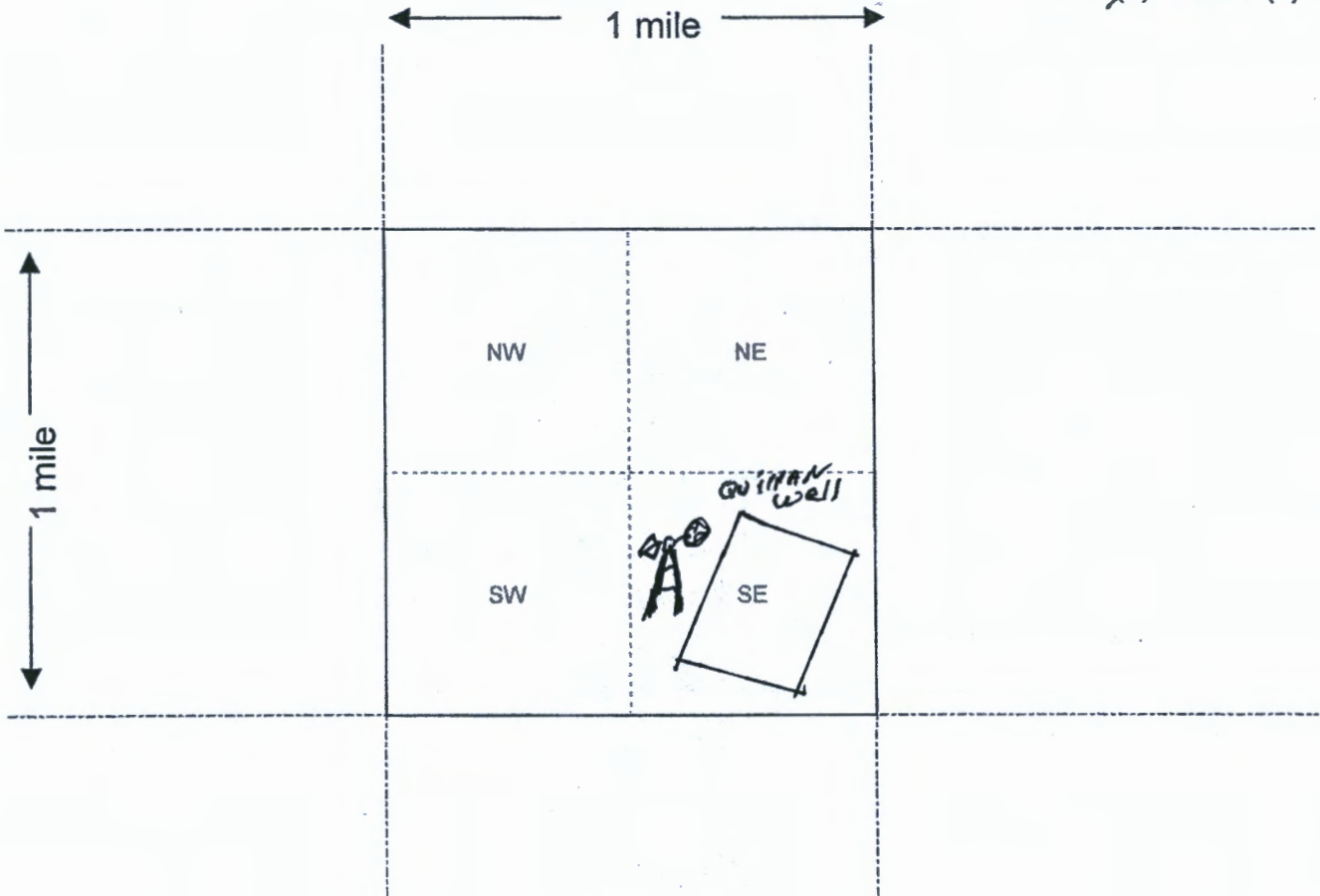

Scale : 1" = 2000 feet



1. The above map depicts the Fuerto del Dado mining claim, which is located in Section (s) 10, Township 15 S., Range 28 EAST, Gila and Salt River Base and Meridian, Cochise County, Arizona.
2. The type of corner and location monuments used are as follows: STONE & 2x2's
OF WOOD
3. The bearings and distances in degrees and feet between claim corners are as depicted on the map.

Form MCF100a
Revised July 2005

Date and Time Run:
7/29/2020 3:33:44 PM

Page 1 of 1

DEPARTMENT OF THE INTERIOR
BUREAU OF LAND MANAGEMENT
Case Recordation

Geographic Report with Land

Disposition is equal to **AUTHORIZED , CANCELLED , EXPIRED , PENDING , REJECTED , RELINQUISHED ,
WITHDRAWN**

and Meridian Township Range Section is equal to 14 0150S 0280E 010

and Admin State is equal to AZ

**NO WARRANTY IS MADE BY BLM
FOR USE OF THE DATA FOR
PURPOSES NOT INTENDED BY BLM**

DEPARTMENT OF THE INTERIOR
BUREAU OF LAND MANAGEMENT
Case Recordation
Geographic Report with Land

Admin State: AZ
Geo State: AZ
Serial Number: AZA 032832

Total Case Acres: 0.008

Casetype	Case Disp	Mer	Twp	Rng	Sec	Sur Type	Sur Nr	Suf	Subdivision	Pending Action
286001	AUTHORIZED	14	0150S	0280E	010	ALIQ			SESE;	Y

Admin State: AZ
Geo State: AZ
Serial Number: AZAR 0035307

Total Case Acres: 590.000

Casetype	Case Disp	Mer	Twp	Rng	Sec	Sur Type	Sur Nr	Suf	Subdivision	Pending Action
231170	AUTHORIZED	14	0150S	0280E	010	MNR			S2N2NE;	

Ioli David
310 W. 21st Ave.
Apache Jct.
ARIZONA 85120

PHOENIX AZ 852

22 JUL 2020 PM 3 L

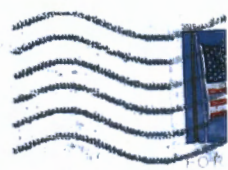

BUREAU OF LAND MANAGEMENT
ARIZONA STATE OFFICE
ONE NORTH CENTRAL Ave. Suite 800
MINING CLAIMS DEPT
Phoenix, ARIZONA 85004-4427

PHOENIX ARIZONA

2020 JUL 24 P 2:44

RECEIVED
BLM AZ STATE OFFICE

85004-442700

